

## INSTALLATION INSTRUCTIONS

### INSTALLATION MANUAL

#### Tools You Will Need:



Plumber's putty



Pipe tape



Model number: LFW100-XX-SPOUT /  
LFW100-XX-MCHND /  
WE01012400002903XX



Philips Screwdriver

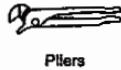

Pliers



Adjustable wrench

#### Available Handle Options

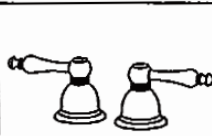

▲ LFW100-XX-MLHND

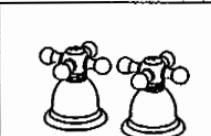

▲ LFW100-XX-MCHND



▲ LFW102-XX-MCHND

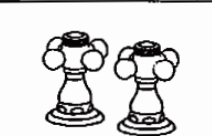

▲ LFW102-XX-PCHND

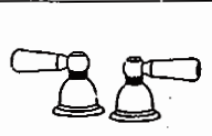

▲ LFW100-XX-PLHND

#### Two-handle Lavatory Faucet

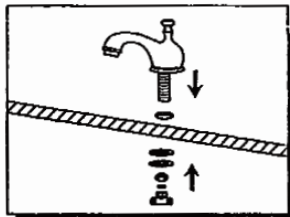

1. Apply silicone sealant around bottom of spout, place spout in center hole of sink. Secure with pictured parts.

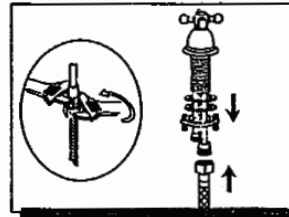

2. Remove mounting hardware from handle body. Connect water supply tube to valve body and tighten with lock nut. Do not allow the water supply brass tube to twist. Use two wrenches, as shown in the diagram. Tighten wrench tight.

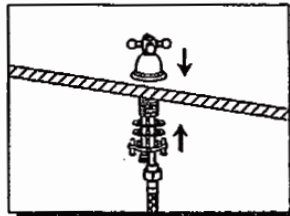

3. Place the handle body through right hole. Re-assemble the parts and screw with lock nut.

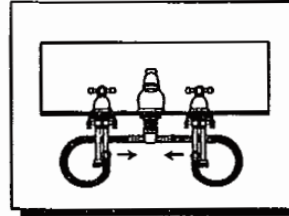

4. Connect handle body and faucet body with braided hoses and tighten with lock nut.

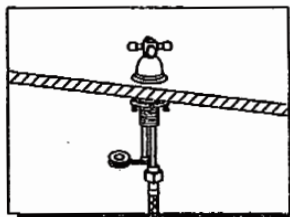

5. Apply pipe tape on the thread of inlet port.

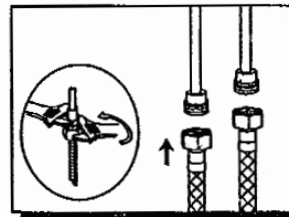

6. Tighten end of shank with wrench and slip coupling nut onto inlet port. Do not allow the water supply brass tube to twist. Use two wrenches, as shown in the diagram. Tighten wrench tight.



# Single Handle Lavatory Faucet LFW100

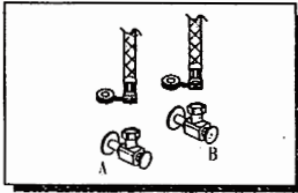

7. Connect to water supply.

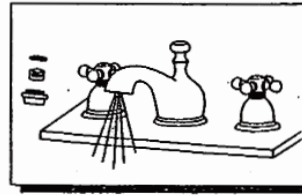

8. After installing faucet, remove aerator and turn on water to remove any left over debris. Re-assemble aerator.

## Exploded Drawing:

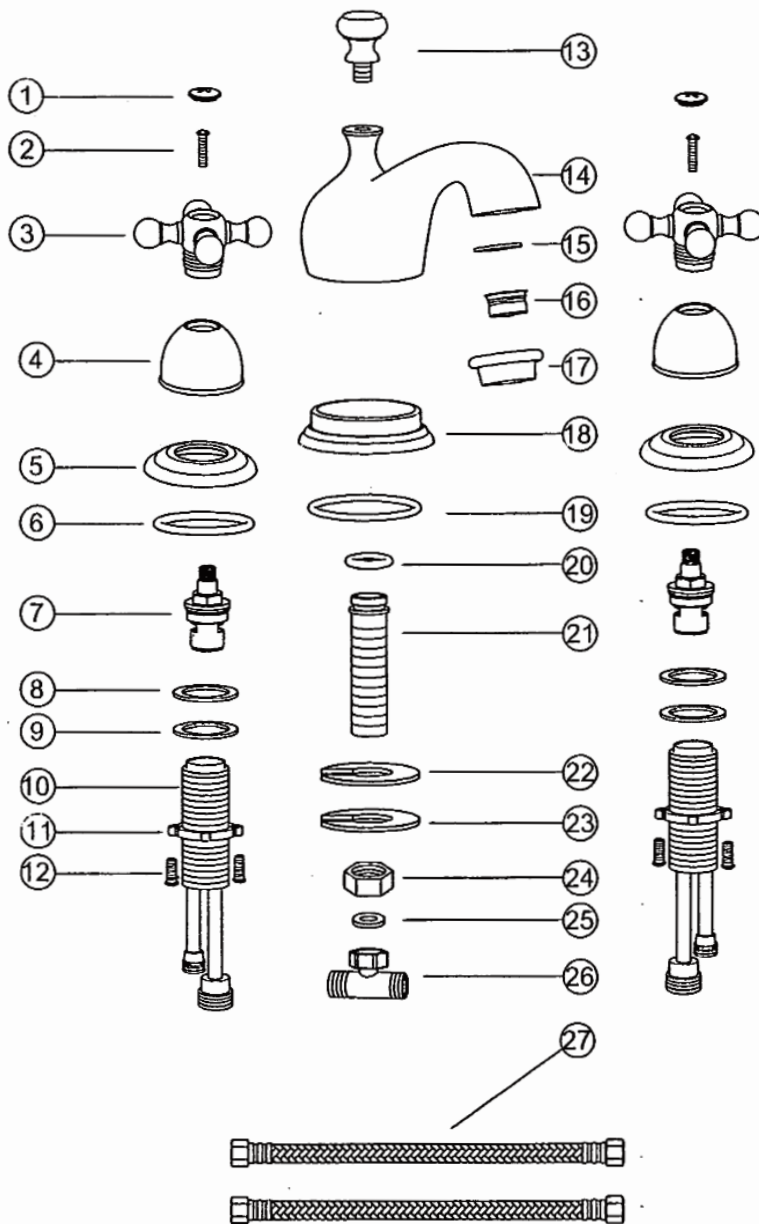

27	Braided Hose	2
26	Adapter	1
25	Gasket	1
24	Lock Nut	1
23	Metal Washer	1
22	Rubber Washer	1
21	Shank	1
20	O-ring	1
19	O-ring	1
18	Trim Ring	1
17	Aerator Cover	1
16	Aerator	1
15	Gasket	1
14	Faucet Body	1
13	Spout Trim Cap	1
12	Screw	4
11	Lock Nut	2
10	Valve Body	2
9	Metal Washer	2
8	Rubber Washer	2
7	Ceramic Disc Cartridge	2
6	O-ring	2
5	Trim Ring	2
4	Canopy	2
3	Handle	2
2	Screw	2
1	Handle Cap	2
No.	Part Description	Quantity